

## Vertical Dipole Assembly Instructions

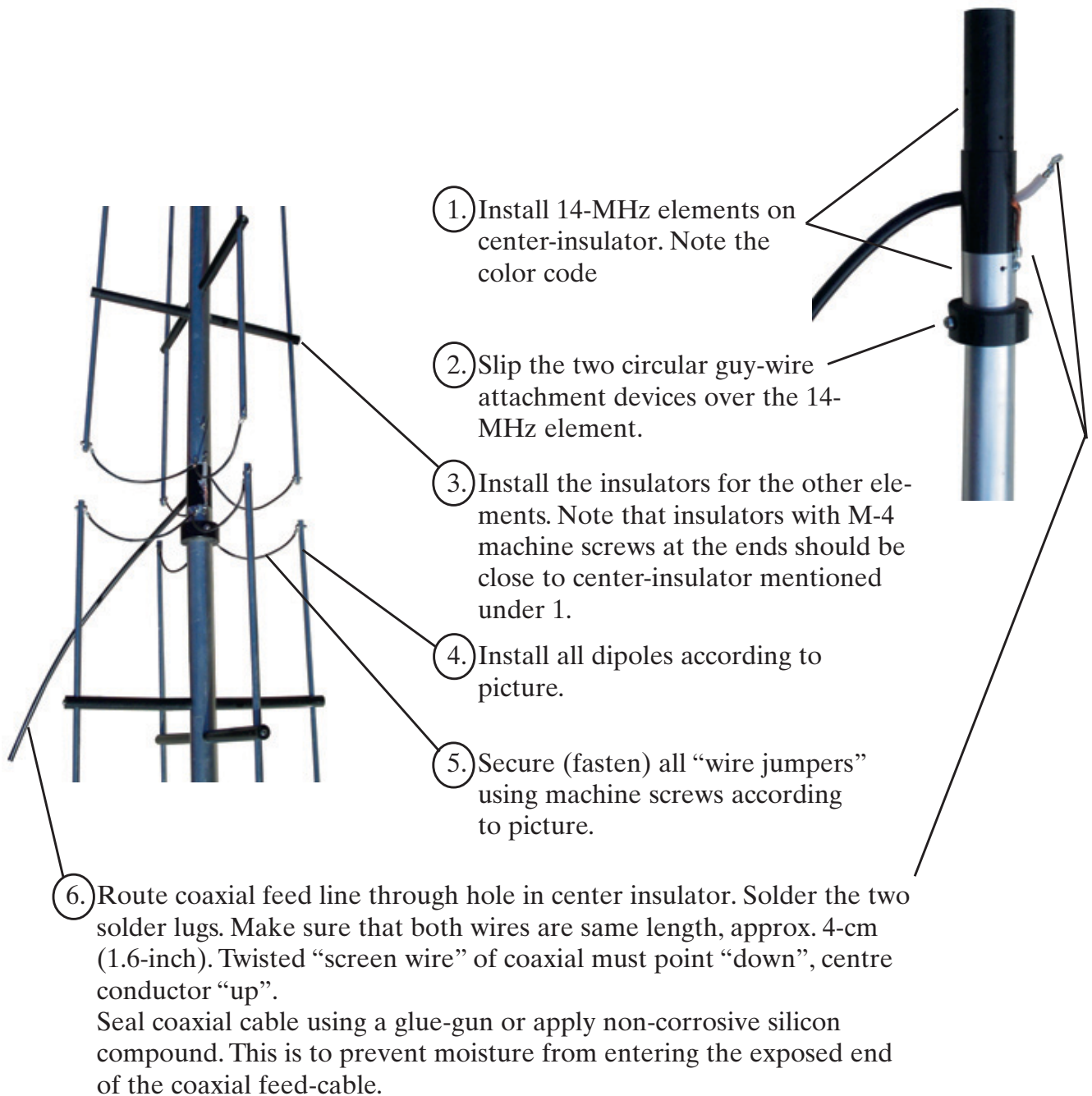

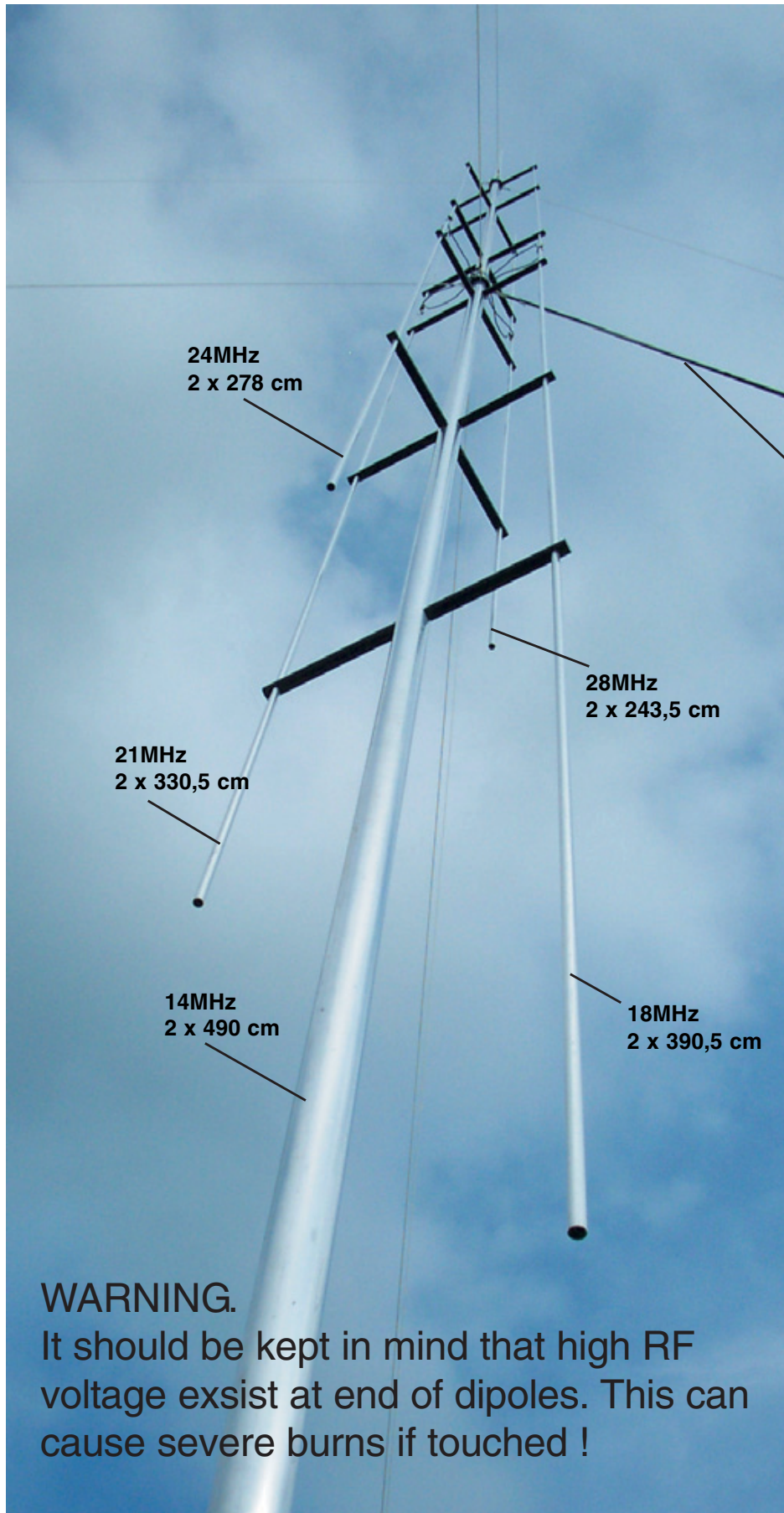

7. Attach coaxial feedline to one of the guy-wires. Use UV-resistant (black) cable ties.

Note that coaxial cable should slope down approx. 45 degrees away from the antenna.

Preferably, two sets of guy-wires at different levels should be used. Use non-conductive, UV-resistant material for guy-wires. (e.g. Kevlar rope)

Antenna “bottom insulator” should be installed 50 - 100cm ( 3.3-feet) above ground.

Antenna can handle the same amount of power as the coaxial cable feeding the array.

This antenna is designed to withstand the severe weather conditions common on the West Coast of Sweden.

## WARNING.

It should be kept in mind that high RF voltage exist at end of dipoles. This can cause severe burns if touched !

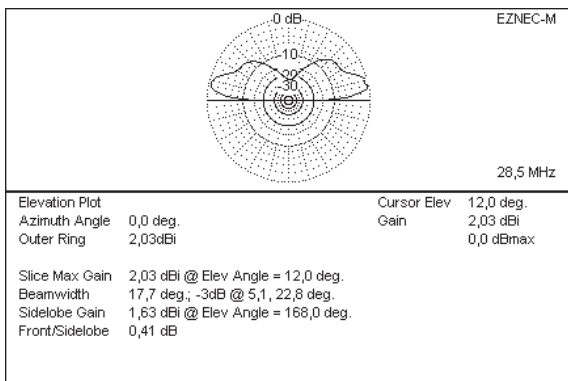
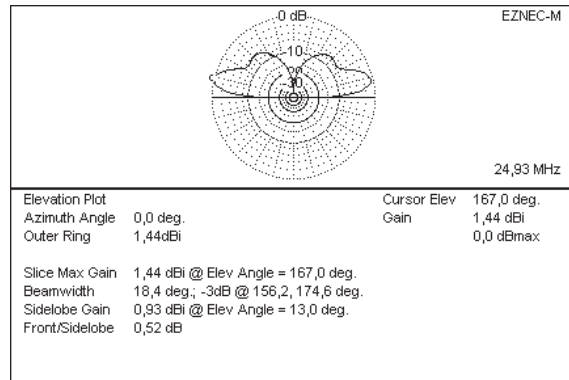
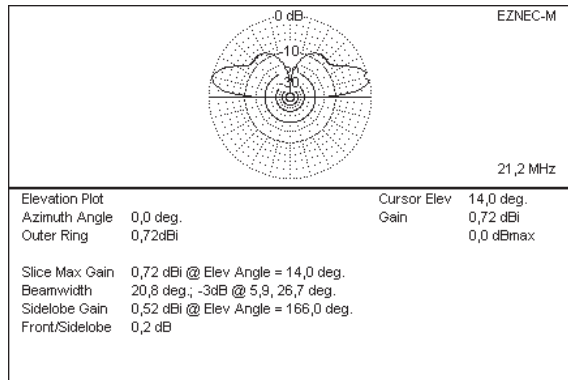
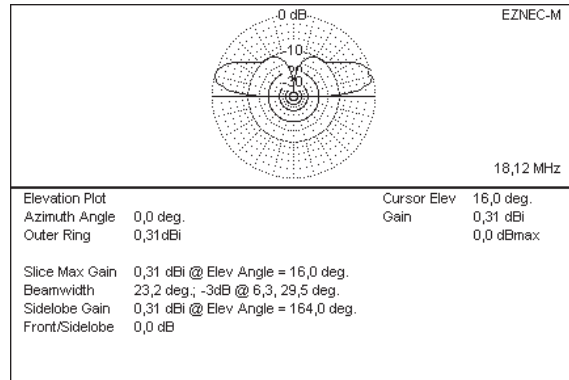
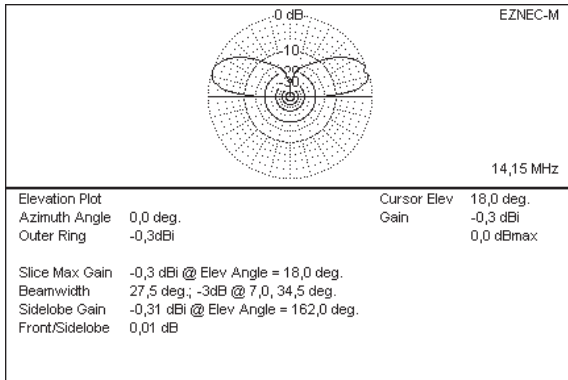

Radiation lobes are depicted in the attached diagrams on the following frequencies:

- 14.150 MHz
- 18.120 MHz
- 21.200 MHz
- 24.930 MHz
- 28.500 MHz